



FAS 3-M - Final Assembly Station gen 3. manual

For the connector- generation Hirschmann HPS

Product description

The FAS 3-M Final Assembly Station HPS is used for press-fitting the components contact carrier and socket housing of the HPS 40 series.

After inserting the contact carrier and socket housing, they are pressed by operating the hand lever, while an initial stroke simultaneously eliminates the housing tolerance.

Advantages

- ✓ No operator software necessary, very easy handling
- ✓ Control mechanism for correct insertion
- ✓ Initial Stroke for Elimination of Tolerance
- ✓ High Process security

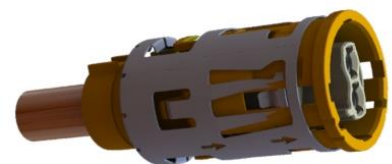

Configuration



Base Press Final Assembly Station

Art. Nr.: 204596

Exchangeable tool inserts to press (FAS3-M & FAS1-E) – Hirschmann PowerStar to assemble the last process step:

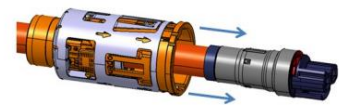

HPS 40-1 (HTC4&ODU)*	ATS1-1
HPS40-2 (with CPA)	ATS1-2C
HPS40-2 (NAFTA)	ATS1-2N
HPS40-2 Plus	ATS1-2P
HPS40-4+2	ATS1-4
HPS40-2 InLine	ATS1-I
HPS40-2 InLine Plus	ATS1-IP

Art. Nr.: 204447
Art. Nr.: 204448
Art. Nr.: 204449
Art. Nr.: 205776
Art. Nr.: 204450
Art. Nr.: 204444
Art. Nr.: 205614

Further interchangeable toolsets:

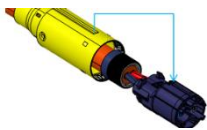

Contact carrier in shield sleeve HPS40-2 IN+

Art. Nr.: 215414

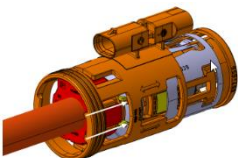

HPS40-2 assembling overhousing

Art. Nr.: 215414

Technical Data

Processed materials

Plug-generation	Hirschmann HPS
-----------------	----------------

Daten

Pressing process	pneumatic
Pressure	6 Bar unoiled, clean air
WxHxD	220 x 430x 175 mm
Weight	25kg/ 55,11lbs

Auxiliary devices – Hirschmann PowerStar:

HPS40-2

Measurement device

Art. Nr.: 207829

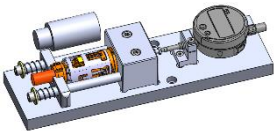

HPS40-2 inline

Measurement device

Art. Nr.: 203214

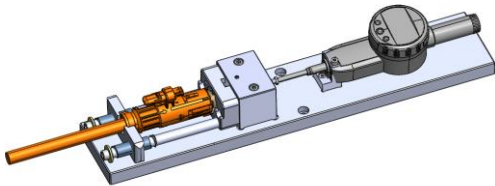

**WKM furthermore enables customers a process secure shield sleeve crimping for the Hirschmann HPS Series and assembly devices for Rosenberger connectors
Additionally, we manufacture special machinery according to customer's needs.**

The FAS1-E+M toolsets are exchangeable with our manual Final Assembly Station (FAS3-M) toolsets.
*(except HPS40-1 cable pulling mechanism)

Contact

WKM Maschinenbau GmbH
Oberes Ried 15 I 6833 Klaus/Vorarlberg I Austria
Phone. +43 5523 54907 I Fax +43 5523 54907-50
sales@wkm.at | www.wkm.at

